

(75) 6' dia. tables  
 (10) People per table  
 Capacity: 750 People

Minimum Aisle Widths:  
 4'-6" wide within table clusters  
 6' wide at primary circulation

# Community – Maximum Dining Hall Layout

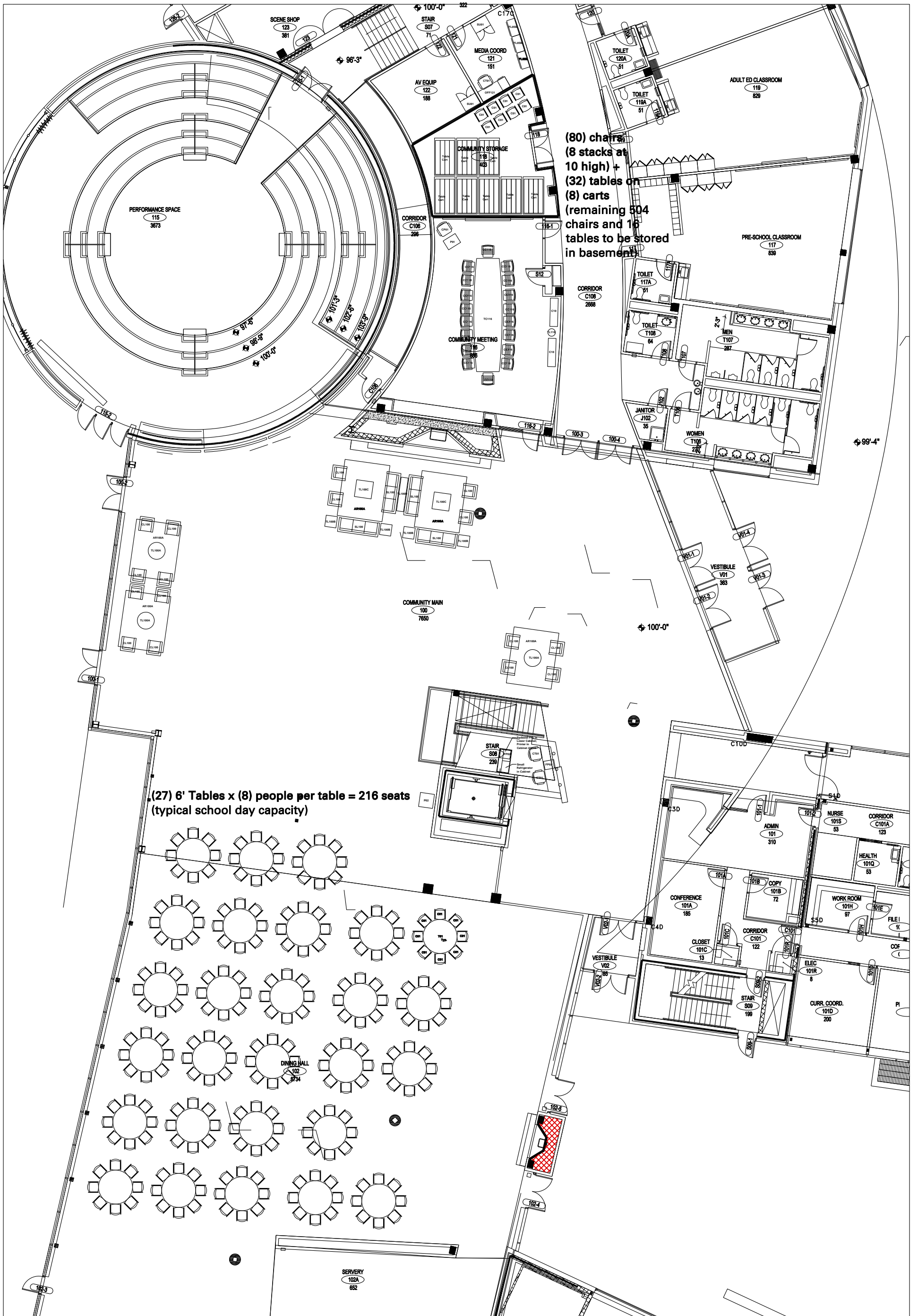

# Community – Typical Dining Layout

Indian Community School

10405 West St. Martins Road  
Franklin, WI 53132

February 26, 2007

Project No: 01530

Scale: 1/16" = 1'-0" 

TheEnvironmentsGroup

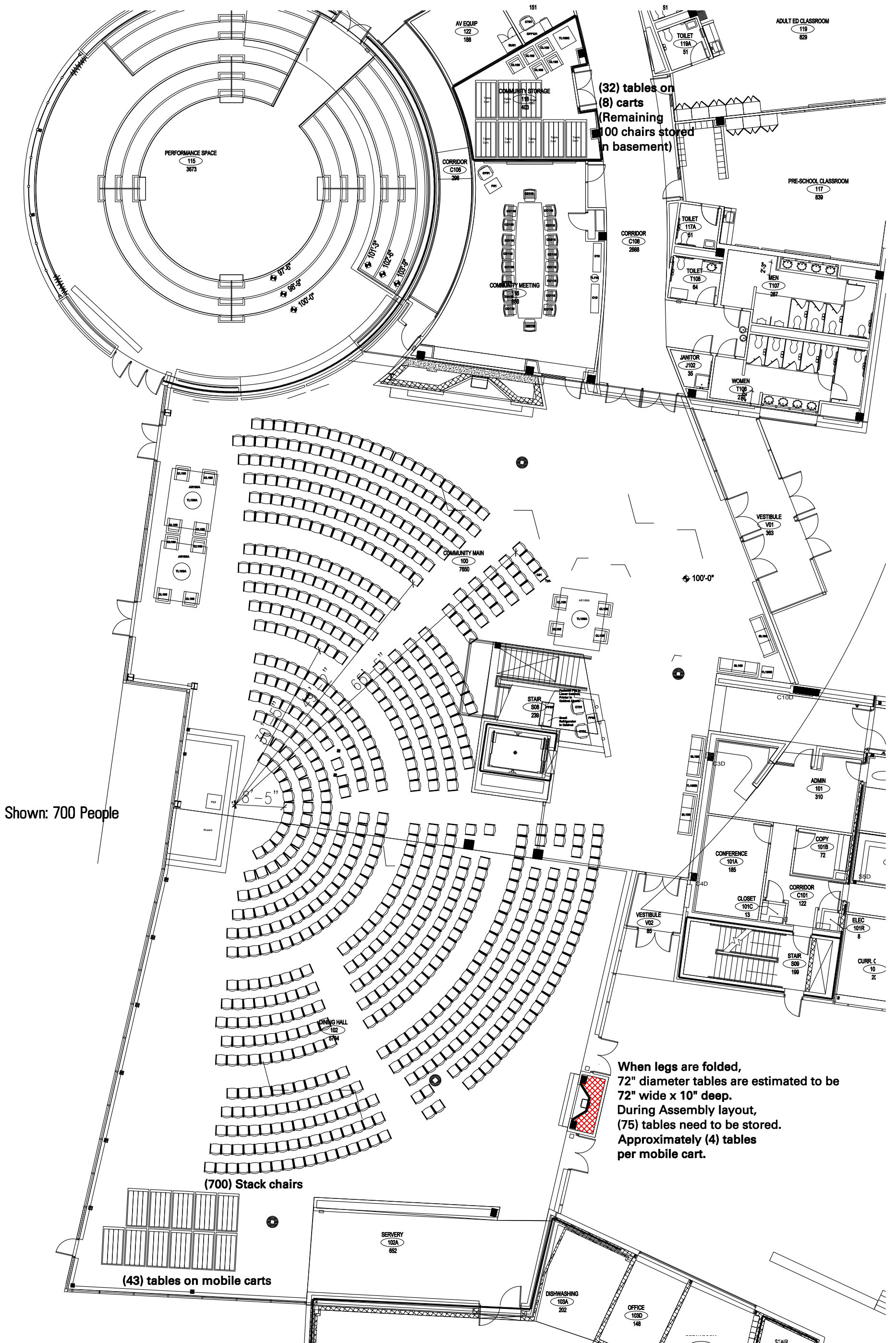

Shown: 700 People

(32) tables on  
(8) carts  
(Remaining  
100 chairs stored  
in basement)

When legs are folded,  
72" diameter tables are estimated to be  
72" wide x 10" deep.  
During Assembly layout,  
(75) tables need to be stored.  
Approximately (4) tables  
per mobile cart.

## Community – Assembly Layout



Indian Community School

FFE Inventory

26-Feb-07

FLOOR	AREA	ROOM NAME	ROOM NUMBER	ROOM USE	CONCEPT/S YMBOL	ITEM NAME	CODE	ITEM DESCRIPTION	ITEM QUANTITY	STANDARD OR NONSTANDARD	NOTES
1	D	Community Main	100	Assembly	NA	lounge chairs	CL02		16		
1	D	Community Main	100	Assembly	NA	sofa	SL100		4		
1	D	Community Main	100	Assembly	NA	area rug	AR100A		5		
1	D	Community Main	100	Assembly	NA	coffee table	TL100A		3		
1	D	Community Main	100	Assembly	NA	coffee table	TL100B		4		
1	D	Community Main	100	Assembly	NA	risers	Risers				
1	D	Community Main	100	Assembly	NA	coffee table	TL100C		2		
1	D	Community Main	100	Assembly	NA	sideboard	TL100D		1		
1	D	Dining Hall	102	Assembly	NA	dining chair	C01		800		
1	D	Dining Hall	102	Assembly	NA	dining table	T01		75		